

BUY & SELL CONVEYANCING SERVICES

Phone: 5968 6431
Fax: 8738 1546
PO BOX 223 EMERALD VIC 3782
annette@buyandsellconveyancing.com.au



Vendor Statement

The vendor makes this statement in respect of the land in accordance with section 32 of the *Sale of Land Act 1962*.

This statement must be signed by the vendor and given to the purchaser before the purchaser signs the contract.
The vendor may sign by electronic signature.

The purchaser acknowledges being given this statement signed by the vendor with the attached documents before the purchaser signed any contract.

50 Beaconsfield-Emerald Road, Emerald VIC 3782

Vendor's name	Mark Frank Agius	Date
Vendor's signature		16 / 12 / 2023
Vendor's name	Corinne Ann Agius	Date
Vendor's signature		16 / 12 / 2023

Purchaser's name		Date
Purchaser's signature	<hr/>	/ /
Purchaser's name		Date
Purchaser's signature	<hr/>	/ /

1. FINANCIAL MATTERS

1.1 Particulars of any Rates, Taxes, Charges or Other Similar Outgoings (and any interest on them)

At settlement the rates will be adjusted between the parties, so that they each bear the proportion of rates applicable to their respective periods of occupancy in the property.

Cardinia Shire Council
Yarra Valley Water

(a) Their total does not exceed:

\$4,500.00 p.a.

(b) Land Tax may be applicable if the land value exceeds \$250,000.00 or a change of use occurs. The purchaser will remain liable for any adjusted increase in a new Land Tax Assessment after the 31st of December 2023.

1.2 Particulars of any Charge (whether registered or not) imposed by or under any Act to secure an amount due under that Act, including the amount owing under the charge.

Not Applicable

1.3 Terms Contract

This section 1.3 only applies if this vendor statement is in respect of a terms contract where the purchaser is obliged to make 2 or more payments (other than a deposit or final payment) to the vendor after the execution of the contract and before the purchaser is entitled to a conveyance or transfer of the land.

Not Applicable.

1.4 Sale Subject to Mortgage

This section 1.4 only applies if this vendor statement is in respect of a contract which provides that any mortgage (whether registered or unregistered), is NOT to be discharged before the purchaser becomes entitled to possession or receipts of rents and profits.

Not Applicable.

2. INSURANCE

2.1 Damage and Destruction

This section 2.1 only applies if this vendor statement is in respect of a contract which does NOT provide for the land to remain at the risk of the vendor until the purchaser becomes entitled to possession or receipt of rents and profits.

Not Applicable.

2.2 Owner Builder

This section 2.2 only applies where there is a residence on the land that was constructed by an owner-builder within the preceding 6 years and section 137B of the Building Act 1993 applies to the residence.

Not Applicable.

3. LAND USE

3.1 Easements, Covenants or Other Similar Restrictions

(a) A description of any easement, covenant or other similar restriction affecting the land (whether registered or unregistered):

As attached.

(b) Particulars of any existing failure to comply with that easement, covenant or other similar restriction are:

Not Applicable

The Purchaser/s should note sewers, drains, water pipes, underground and/or overhead electricity cables, underground and/or overhead telephone cables, underground NBN cables and underground gas pipes if any, may be laid outside registered easements.

3.2 Road Access

There is NO access to the property by road if the square box is marked with an 'X'



3.3 Designated Bushfire Prone Area

The land is in a designated bushfire prone area within the meaning of regulations made under the *Building Act 1993* if the square box is marked with an 'X'

3.4 Planning Scheme

Attached is a certificate with the required specified information.

4. NOTICES

4.1 Notice, Order, Declaration, Report or Recommendation

Particulars of any notice, order, declaration, report or recommendation of a public authority or government department or approved proposal directly and currently affecting the land, being a notice, order, declaration, report, recommendation or approved proposal of which the vendor might reasonably be expected to have knowledge:

Not Applicable.

The Vendor has no means of knowing decisions of all public authorities and government departments affecting the property unless communicated to the Vendor.

The property is in an area in which is classified as an area in which buildings are likely to be subject to infestation of termites.

4.2 Agricultural Chemicals

There are NO notices, property management plans, reports or orders in respect of the land issued by a government department or public authority in relation to livestock disease or contamination by agricultural chemicals affecting the ongoing use of the land for agricultural purposes. However, if this is not the case, the details of any such notices, property management plans, reports or orders, are as follows:

Nil.

4.3 Compulsory Acquisition

The particulars of any notices of intention to acquire that have been served under section 6 of the *Land Acquisition and Compensation Act 1986* are as follows:

Nil.

5. BUILDING PERMITS

Particulars of any building permit issued under the *Building Act 1993* in the preceding 7 years (required only where there is a residence on the land):

Nil.

6. OWNERS CORPORATION

This section 6 only applies if the land is affected by an owners corporation within the meaning of the *Owners Corporations Act 2006*.

Not Applicable.

7. GROWTH AREAS INFRASTRUCTURE CONTRIBUTION ("GAIC")

Words and expressions in this section 7 have the same meaning as in Part 9B of the *Planning and Environment Act 1987*.

Not Applicable

8. SERVICES

The services which are marked with an 'X' in the accompanying square box are NOT connected to the land:

Electricity supply <input type="checkbox"/>	Gas supply <input type="checkbox"/>	Water supply <input type="checkbox"/>	Sewerage <input checked="" type="checkbox"/>	Telephone services <input type="checkbox"/>
---	-------------------------------------	---------------------------------------	--	---

- Some services currently noted as connected above may become disconnected prior to settlement. The Purchaser should make their own enquiries in relation to connection and re-connection of services to the land.

9. TITLE

Attached are copies of the following documents:

9.1 Registered Title

A Register Search Statement and the document, or part of a document, referred to as the 'diagram location' in that statement which identifies the land and its location.

10. SUBDIVISION

10.1 Unregistered Subdivision

This section 10.1 only applies if the land is subject to a subdivision which is not registered.

Not Applicable.

10.2 Staged Subdivision

This section 10.2 only applies if the land is part of a staged subdivision within the meaning of section 37 of the *Subdivision Act 1988*.

Not Applicable.

10.3 Further Plan of Subdivision

This section 10.3 only applies if the land is subject to a subdivision in respect of which a further plan within the meaning of the *Subdivision Act 1988* is proposed.

Not Applicable.

11. DISCLOSURE OF ENERGY INFORMATION

(Disclosure of this information is not required under section 32 of the Sale of Land Act 1962 but may be included in this vendor statement for convenience.)

Details of any energy efficiency information required to be disclosed regarding a disclosure affected building or disclosure area affected area of a building as defined by the *Building Energy Efficiency Disclosure Act 2010* (Cth)

- (a) to be a building or part of a building used or capable of being used as an office for administrative, clerical, professional or similar based activities including any support facilities; and
- (b) which has a net lettable area of at least 2000m²; (but does not include a building under a strata title system or if an occupancy permit was issued less than 2 years before the relevant date):

Not Applicable.

12. DUE DILIGENCE CHECKLIST

(The Sale of Land Act 1962 provides that the vendor or the vendor's licensed estate agent must make a prescribed due diligence checklist available to purchasers before offering land for sale that is vacant residential land or land on which there is a residence. The due diligence checklist is NOT required to be provided with, or attached to, this vendor statement but the checklist may be attached as a matter of convenience.)

Is attached.

13. ATTACHMENTS

(Any certificates, documents and other attachments may be annexed to this section 13)

(Additional information may be added to this section 13 where there is insufficient space in any of the earlier sections)

(Attached is an "Additional Vendor Statement" if section 1.3 (Terms Contract) or section 1.4 (Sale Subject to Mortgage) applies)

Water Information Statement

PLANNING CERTIFICATE

Official certificate issued under Section 199 Planning & Environment Act 1987
and the Planning and Environment Regulations 2005

CERTIFICATE REFERENCE NUMBER

985529

APPLICANT'S NAME & ADDRESS

BUY & SELL CONVEYANCING SERVICES C/- TRICONVEY
(RESELLER) C/- LANDATA
DOCKLANDS

VENDOR

AGIUS, MARK FRANK

PURCHASER

NOT KNOWN, NOT KNOWN

REFERENCE

359244

This certificate is issued for:

LOT 1 PLAN LP13129 ALSO KNOWN AS 50 BEACONSFIELD-EMERALD ROAD EMERALD
CARDINIA SHIRE

The land is covered by the:

CARDINIA PLANNING SCHEME

The Minister for Planning is the responsible authority issuing the Certificate.

The land:

- is included in a LOW DENSITY RESIDENTIAL ZONE - SCHEDULE 2
- is within a BUSHFIRE MANAGEMENT OVERLAY
- and a VEGETATION PROTECTION OVERLAY - SCHEDULE 1
- and a DESIGN AND DEVELOPMENT OVERLAY - SCHEDULE 1
- and a RESTRUCTURE OVERLAY - SCHEDULE 33
- and abuts a TRANSPORT ZONE 2 - PRINCIPAL ROAD NETWORK
- and is AREA OUTSIDE THE URBAN GROWTH BOUNDARY

A detailed definition of the applicable Planning Scheme is available at :
(<http://planningschemes.dpcd.vic.gov.au/schemes/cardinia>)

Historic buildings and land protected under the Heritage Act 1995 are recorded in the Victorian
Heritage Register at:
<http://vhd.heritage.vic.gov.au/>

29 November 2023

Sonya Kilkenny
Minister for Planning

Additional site-specific controls may apply.
The Planning Scheme Ordinance should be
checked carefully.
The above information includes all
amendments to planning scheme maps
placed on public exhibition up to the date
of issue of this certificate and which are
still the subject of active consideration

Copies of Planning Schemes and
Amendments can be inspected at the
relevant municipal offices.

LANDATA@
T: (03) 9102 0402
E: landata.enquiries@servictoria.com.au

The attached certificate is issued by the Minister for Planning of the State of Victoria and is protected by statute.

The document has been issued based on the property information you provided. You should check the map below - it highlights the property identified from your information.

If this property is different to the one expected, you can phone (03) 9102 0402 or email landata.enquiries@servictoria.com.au

Please note: The map is for reference purposes only and does not form part of the certificate.

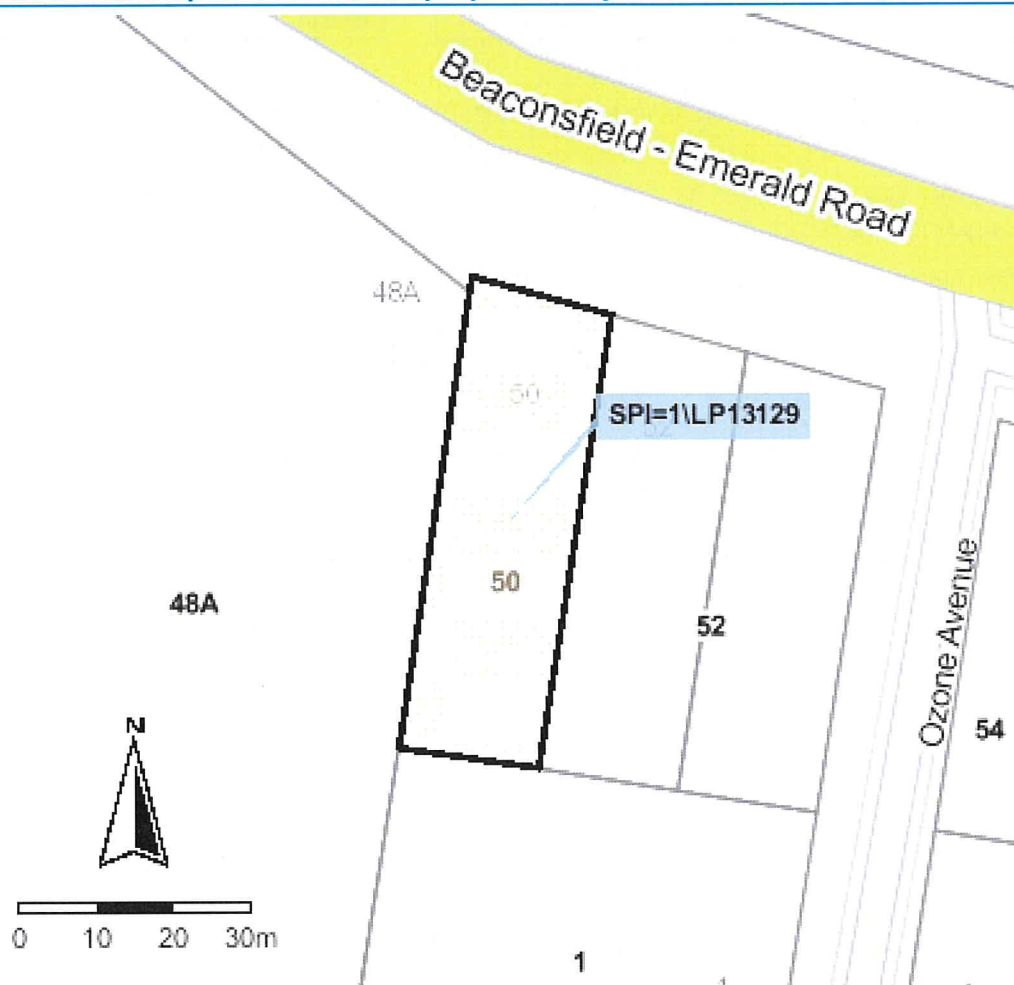

Copyright © State Government of Victoria. Service provided by maps.land.vic.gov.au

Choose the authoritative Planning Certificate

Why rely on anything less?

As part of your section 32 statement, the authoritative Planning Certificate provides you and / or your customer with the statutory protection of the State of Victoria.
Order online before 4pm to receive your authoritative Planning Certificate the same day, in most cases within the hour.
Next business day delivery, if further information is required from you.

Privacy Statement

The information obtained from the applicant and used to produce this certificate was collected solely for the purpose of producing this certificate. The personal information on the certificate has been provided by the applicant and has not been verified by LANDATA®. The property information on the certificate has been verified by LANDATA®. The zoning information on the certificate is protected by statute. The information on the certificate will be retained by LANDATA® for auditing purposes and will not be released to any third party except as required by law.



Copyright State of Victoria. No part of this publication may be reproduced except as permitted by the Copyright Act 1968 (Cth), to comply with a statutory requirement or pursuant to a written agreement. The information is only valid at the time and in the form obtained from the LANDATA REGD TM System. None of the State of Victoria, its agents or contractors, accepts responsibility for any subsequent publication or reproduction of the information.

The Victorian Government acknowledges the Traditional Owners of Victoria and pays respects to their ongoing connection to their Country, History and Culture. The Victorian Government extends this respect to their Elders, past, present and emerging.

**REGISTER SEARCH STATEMENT (Title Search) Transfer of
Land Act 1958**

Page 1 of 1

VOLUME 08110 FOLIO 113

Security no : 124110855550Q
Produced 29/11/2023 09:42 AM

LAND DESCRIPTION

Lot 1 on Plan of Subdivision 013129.
PARENT TITLE Volume 07767 Folio 005
Created by instrument A154125 10/05/1956

REGISTERED PROPRIETOR

Estate Fee Simple
Joint Proprietors
MARK FRANK AGIUS
CORINNE ANN AGIUS both of 4 ASH GROVE MENZIES CREEK VIC 3159
AF053994L 09/05/2007

ENCUMBRANCES, CAVEATS AND NOTICES

MORTGAGE AR355720N 16/08/2018
COMMONWEALTH BANK OF AUSTRALIA

Any encumbrances created by Section 98 Transfer of Land Act 1958 or Section 24 Subdivision Act 1988 and any other encumbrances shown or entered on the plan or imaged folio set out under DIAGRAM LOCATION below.

DIAGRAM LOCATION

SEE LP013129 FOR FURTHER DETAILS AND BOUNDARIES

ACTIVITY IN THE LAST 125 DAYS

NIL

-----END OF REGISTER SEARCH STATEMENT-----

Additional information: (not part of the Register Search Statement)

Street Address: 50 BEACONSFIELD-EMERALD ROAD EMERALD VIC 3782

ADMINISTRATIVE NOTICES

NIL

eCT Control 15940N COMMONWEALTH BANK OF AUSTRALIA
Effective from 16/08/2018

DOCUMENT END



Imaged Document Cover Sheet

The document following this cover sheet is an imaged document supplied by LANDATA®, Secure Electronic Registries Victoria.

Document Type	Plan
Document Identification	LP013129
Number of Pages (excluding this cover sheet)	2
Document Assembled	29/11/2023 09:42

Copyright and disclaimer notice:

© State of Victoria. This publication is copyright. No part may be reproduced by any process except in accordance with the provisions of the Copyright Act 1968 (Cth) and for the purposes of Section 32 of the Sale of Land Act 1962 or pursuant to a written agreement. The information is only valid at the time and in the form obtained from the LANDATA® System. None of the State of Victoria, LANDATA®, Secure Electronic Registries Victoria Pty Ltd (ABN 86 627 986 396) as trustee for the Secure Electronic Registries Victoria Trust (ABN 83 206 746 897) accept responsibility for any subsequent release, publication or reproduction of the information.

The document is invalid if this cover sheet is removed or altered.

PLAN OF SUBDIVISION
 OF PART OF CROWN ALLOTMENT I
PARISH OF GEMBROOK
 COUNTY OF MORNINGTON

COLOUR CODE

- E-1 = BLUE
- R1 = BROWN
- E-3 = BLUE HATCHED OVER BLUE
- E-4 = RED HATCHED OVER BLUE
- E-5 = RED HATCHED OVER BROWN
- E-6 = BLUE HATCHED OVER BROWN
- E-7 = RED CROSS HATCHED OVER BROWN

LP 13129

EDITION 1
 PLAN MAY BE LODGED 6/2/29.

2 SHEETS
SHEET 1

Measurements are in Feet & Inches

Conversion Factor
FEET X 0.3048 = METRES

Vol 4810 Fol 9C1959

ROAD CROSS HATCHED RED OVER BROWN
 DISCONTINUED VIDE A.O. IN L.G.D. 2796
 18 - 11 - 81

THE DRAINAGE EASEMENT
 HATCHED BLUE OVER BLUE
 NO LONGER AFFECTS
 VIDE J240926 (SEC 54)
 10 - 3 - 81

ROADS HATCHED RED OVER BROWN
 DISCONTINUED VIDE A.O. IN L.G.D. 2796
 18 - 11 - 81

The drainage easement
 hatched red over blue
 no longer affects

ROADS HATCHED BLUE OVER BROWN
 DISCONTINUED VIDE A.O. IN L.G.D. 3475
 26 - 8 - 82

VIDE J240928 (SEC 54)
 18 - 2 - 81

APPROPRIATIONS

THE LAND COLOURED BLUE
 IS APPROPRIATED OR SET
 APART FOR EASEMENTS OF
 DRAINAGE

THE LAND COLOURED BROWN
 IS APPROPRIATED OR SET
 APART FOR ROADS

STREET NAME AMENDED
 FROM PATERNOSTER ROAD
 TO BEACONSFIELD-EMERALD R1
 VIDE CORR. 83/33879

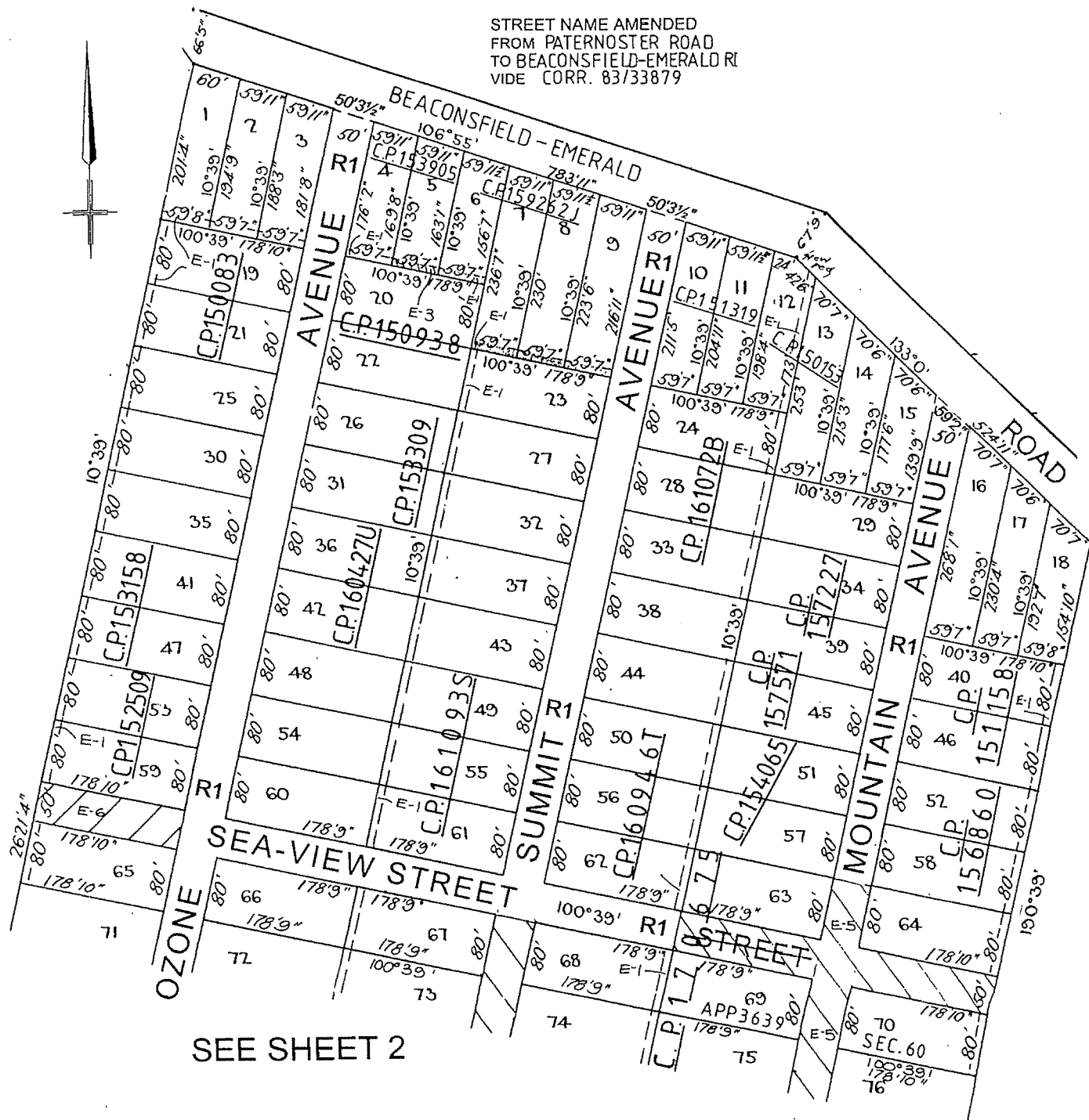

SEE SHEET 2



YARRA VALLEY WATER
ABN 93 068 902 501

Lucknow Street
Mitcham Victoria 3132

Private Bag 1
Mitcham Victoria 3132

DX 13204

F (03) 9872 1353

E enquiry@yvw.com.au
yvw.com.au

29th November 2023

Buy & Sell Conveyancing Services C/- Triconvey (Re
LANDATA

Dear Buy & Sell Conveyancing Services C/- Triconvey (Re,

RE: Application for Water Information Statement

Property Address:	50 BEACONSFIELD-EMERALD ROAD EMERALD 3782
Applicant	Buy & Sell Conveyancing Services C/- Triconvey (Re LANDATA
Information Statement	30812574
Conveyancing Account Number	7959580000
Your Reference	359244

Thank you for your recent application for a Water Information Statement (WIS). We are pleased to provide you the WIS for the above property address. This statement includes:

- Yarra Valley Water Property Information Statement
- Melbourne Water Property Information Statement
- Asset Plan
- Rates Certificate

If you have any questions about Yarra Valley Water information provided, please phone us on **1300 304 688** or email us at the address enquiry@yvw.com.au. For further information you can also refer to the Yarra Valley Water website at www.yvw.com.au.

Yours sincerely,

Steve Lennox
GENERAL MANAGER
RETAIL SERVICES



YARRA VALLEY WATER
ABN 93 066 902 501

Lucknow Street
Mitcham Victoria 3132

Private Bag 1
Mitcham Victoria 3132

DX 13204

F (03) 9872 1353

E enquiry@yvw.com.au
yvw.com.au

Yarra Valley Water Property Information Statement

Property Address	50 BEACONSFIELD-EMERALD ROAD EMERALD 3782
------------------	---

STATEMENT UNDER SECTION 158 WATER ACT 1989

THE FOLLOWING INFORMATION RELATES TO SECTION 158(3)

Sewerage services have been provided to this property as part of Yarra Valley Water's Community Sewerage Program. To confirm whether the property is connected to sewerage services, please contact Yarra Valley Water on 1300 853 811. For properties not currently connected to sewerage services, please contact Yarra Valley Water on 1300 651 511 to apply to connect.

Existing sewer mains will be shown on the Asset Plan.

Please note: Unless prior consent has been obtained, the Water Act prohibits:

1. The erection and/or placement of any building, wall, bridge, fence, embankment, filling, material, machinery or other structure over or under any sewer or drain.
2. The connection of any drain or sewer to, or interference with, any sewer, drain or watercourse.



YARRA VALLEY WATER
ABN 93 066 902 501

Lucknow Street
Mitcham Victoria 3132

Private Bag 1
Mitcham Victoria 3132

DX 13204

F (03) 9872 1353

E enquiry@yvw.com.au
yvw.com.au

Melbourne Water Encumbrance

Property Address	50 BEACONSFIELD-EMERALD ROAD EMERALD 3782
------------------	---

STATEMENT UNDER SECTION 158 WATER ACT 1989

THE FOLLOWING ENCUMBRANCES RELATE TO SECTION 158(4)

















Information available at Melbourne Water indicates that this property is not subject to flooding from Melbourne Water's drainage system, based on a flood level that has a probability of occurrence of 1% in any one year.

Please note: Unless prior consent has been obtained, the Water Act prohibits:

1. The erection and/or placement of any building, wall, bridge, fence, embankment, filling, material, machinery or other structure over or under any sewer or drain.
2. The connection of any drain or sewer to, or interference with, any sewer, drain or watercourse.

If you have any questions regarding Melbourne Water encumbrances or advisory information, please contact Melbourne Water on 9679 7517.



Yarra Valley Water Information Statement Number: 30812574	Address 50 BEACONSFIELD-EMERALD ROAD EMERALD 3782			 Yarra Valley Water ABN 93 066 902 501	
	Date 29/11/2023				
	Scale 1:1000				
Existing Title	 Access Point Number	GLV2-42	 MW Drainage Channel Centreline		Disclaimer: This information is supplied on the basis Yarra Valley Water Ltd: - Does not warrant the accuracy or completeness of the information supplied, including, without limitation, the location of Water and Sewer Assets; - Does not accept any liability for loss or damage of any nature, suffered or incurred by the recipient or any other persons relying on this information; - Recommends recipients and other persons using this information make their own site investigations and accommodate their works accordingly;
Proposed Title	 Sewer Manhole	 MW Drainage Underground Centreline			
Easement	 Sewer Pipe Flow	 MW Drainage Manhole			
Existing Sewer	 Sewer Offset	 MW Drainage Natural Waterway			
Abandoned Sewer	 Sewer Branch				



YARRA VALLEY WATER
ABN 93 066 902 501

Lucknow Street
Mitcham Victoria 3132

Private Bag 1
Mitcham Victoria 3132

DX 13204

F (03) 9872 1353

E enquiry@yvw.com.au
yvw.com.au

Buy & Sell Conveyancing Services C/- Triconvey (Re
LANDATA
certificates@landata.vic.gov.au

RATES CERTIFICATE

Account No: 4415170000
Rate Certificate No: 30812574

Date of Issue: 29/11/2023
Your Ref: 359244

With reference to your request for details regarding:

Property Address	Lot & Plan	Property Number	Property Type
50 BEACONSFIELD-EMERALD RD, EMERALD VIC 3782	1\LP13129	1699888	Residential

Agreement Type	Period	Charges	Outstanding
Residential Water Service Charge	01-10-2023 to 31-12-2023	\$20.26	\$20.26
Residential Water Usage Charge <i>Step 1 – 40.040000kL x \$2.44510000 = \$15.06</i> <i>Step 1 – 0.000000kL x \$2.49560000 = \$84.55</i> <i>Step 2 – 2.960000kL x \$3.12530000 = \$1.42</i> <i>Step 2 – 0.000000kL x \$3.18980000 = \$7.99</i> Estimated Average Daily Usage \$1.20	16-06-2023 to 15-09-2023	\$109.02	\$0.00
Drainage Fee	01-10-2023 to 31-12-2023	\$16.31	\$16.31
Other Charges:			
Interest	No interest applicable at this time		
	No further charges applicable to this property		
	Balance Brought Forward		\$0.00
	Total for This Property		\$36.57

GENERAL MANAGER
RETAIL SERVICES

Note:

1. From 1 July 2023, the Parks Fee will be charged quarterly instead of annually.
2. From 1 July 2023, for properties that have water and sewer services, the Residential Water and Sewer Usage charge replaces the Residential Water Usage and Residential Sewer Usage charges.
3. This statement details all tariffs, charges, and penalties due and payable to Yarra Valley Water as of the date of this statement and includes tariffs and charges (other than for usage charges yet to be billed) which are due and payable to the end of the current financial quarter.

4. All outstanding debts are due to be paid to Yarra Valley Water at settlement. Any debts that are unpaid at settlement will carry over onto the purchaser's first quarterly account and follow normal credit and collection activities - pursuant to section 275 of the Water Act 1989.
5. If the total due displays a (-\$ cr), this means the account is in credit. Credit amounts will be transferred to the purchaser's account at settlement.
6. Yarra Valley Water provides information in this Rates Certificate relating to waterways and drainage as an agent for Melbourne Water and relating to parks as an agent for Parks Victoria - pursuant to section 158 of the Water Act 1989.
7. The charges on this rates certificate are calculated and valid at the date of issue. To obtain up-to-date financial information, please order a Rates Settlement Statement prior to settlement.
8. From 01/07/2023, Residential Water Usage is billed using the following step pricing system: 249.56 cents per kilolitre for the first 44 kilolitres; 318.98 cents per kilolitre for 44-88 kilolitres and 472.56 cents per kilolitre for anything more than 88 kilolitres. From 1 July 2023, this charge is applicable for properties with water service only.
9. From 01/07/2023, Residential Water and Sewer Usage is billed using the following step pricing system: 334.38 cents per kilolitre for the first 44 kilolitres; 438.73 cents per kilolitre for 44-88 kilolitres and 509.73 cents per kilolitre for anything more than 88 kilolitres. From 1 July 2023, this charge is applicable for residential properties with both water and sewer services.
10. From 01/07/2023, Residential Recycled Water Usage is billed 188.71 cents per kilolitre.
11. From 01/07/2022 up to 30/06/2023, Residential Sewer Usage was calculated using the following equation: Water Usage (kl) x Seasonal Factor x Discharge Factor x Price (/kl) 1.1540 per kilolitre. From 1 July 2023, this charge will no longer be applicable for residential customers with both water and sewer services.
12. The property is a serviced property with respect to all the services, for which charges are listed in the Statement of Fees above.



YARRA VALLEY WATER
ABN 93 056 902 501

Lucknow Street
Mitcham Victoria 3132

Private Bag 1
Mitcham Victoria 3132

DX 13204

F (03) 9872 1353

E enquiry@yvwm.com.au
yvwm.com.au

To ensure you accurately adjust the settlement amount, we strongly recommend you book a Special Meter Reading:

- Special Meter Readings ensure that actual water use is adjusted for at settlement.
- Without a Special Meter Reading, there is a risk your client's settlement adjustment may not be correct.

Property No: 1699888

Address: 50 BEACONSFIELD-EMERALD RD, EMERALD VIC 3782

Water Information Statement Number: 30812574

HOW TO PAY



Bill Code: 314567
Ref: 44151700009

Amount
Paid

Date
Paid

Receipt
Number

Due diligence checklist

What you need to know before buying a residential property

Before you buy a home, you should be aware of a range of issues that may affect that property and impose restrictions or obligations on you, if you buy it. This checklist aims to help you identify whether any of these issues will affect you. The questions are a starting point only and you may need to seek professional advice to answer some of them. You can find links to organisations and web pages that can help you learn more, by visiting the [Due diligence checklist page on the Consumer Affairs Victoria website](http://consumer.vic.gov.au/duediligencechecklist) (consumer.vic.gov.au/duediligencechecklist).

Urban living

Moving to the inner city?

High density areas are attractive for their entertainment and service areas, but these activities create increased traffic as well as noise and odours from businesses and people. Familiarising yourself with the character of the area will give you a balanced understanding of what to expect.

Is the property subject to an owners corporation?

If the property is part of a subdivision with common property such as driveways or grounds, it may be subject to an owners corporation. You may be required to pay fees and follow rules that restrict what you can do on your property, such as a ban on pet ownership.

Growth areas

Are you moving to a growth area?

You should investigate whether you will be required to pay a growth areas infrastructure contribution.

Flood and fire risk

Does this property experience flooding or bushfire?

Properties are sometimes subject to the risk of fire and flooding due to their location. You should properly investigate these risks and consider their implications for land management, buildings and insurance premiums.

Rural properties

Moving to the country?

If you are looking at property in a rural zone, consider:

- Is the surrounding land use compatible with your lifestyle expectations? Farming can create noise or odour that may be at odds with your expectations of a rural lifestyle.
- Are you considering removing native vegetation? There are regulations which affect your ability to remove native vegetation on private property.
- Do you understand your obligations to manage weeds and pest animals?

Can you build new dwellings?

Does the property adjoin crown land, have a water frontage, contain a disused government road, or are there any crown licences associated with the land?

Is there any earth resource activity such as mining in the area?

You may wish to find out more about exploration, mining and quarrying activity on or near the property and consider the issue of petroleum, geothermal and greenhouse gas sequestration permits, leases and licences, extractive industry authorisations and mineral licences.

Soil and groundwater contamination

Has previous land use affected the soil or groundwater?

You should consider whether past activities, including the use of adjacent land, may have caused contamination at the site and whether this may prevent you from doing certain things to or on the land in the future.

(04/10/2016)

Land boundaries

Do you know the exact boundary of the property?

You should compare the measurements shown on the title document with actual fences and buildings on the property, to make sure the boundaries match. If you have concerns about this, you can speak to your lawyer or conveyancer, or commission a site survey to establish property boundaries.

Planning controls

Can you change how the property is used, or the buildings on it?

All land is subject to a planning scheme, run by the local council. How the property is zoned and any overlays that may apply, will determine how the land can be used. This may restrict such things as whether you can build on vacant land or how you can alter or develop the land and its buildings over time.

The local council can give you advice about the planning scheme, as well as details of any other restrictions that may apply, such as design guidelines or bushfire safety design. There may also be restrictions – known as encumbrances – on the property's title, which prevent you from developing the property. You can find out about encumbrances by looking at the section 32 statement.

Are there any proposed or granted planning permits?

The local council can advise you if there are any proposed or issued planning permits for any properties close by. Significant developments in your area may change the local 'character' (predominant style of the area) and may increase noise or traffic near the property.

Safety

Is the building safe to live in?

Building laws are in place to ensure building safety. Professional building inspections can help you assess the property for electrical safety, possible illegal building work, adequate pool or spa fencing and the presence of asbestos, termites, or other potential hazards.

Building permits

Have any buildings or retaining walls on the property been altered, or do you plan to alter them?

There are laws and regulations about how buildings and retaining walls are constructed, which you may wish to investigate to ensure any completed or proposed building work is approved. The local council may be able to give you information about any building permits issued for recent building works done to the property, and what you must do to plan new work. You can also commission a private building surveyor's assessment.

Are any recent building or renovation works covered by insurance?

Ask the vendor if there is any owner-builder insurance or builder's warranty to cover defects in the work done to the property.

Utilities and essential services

Does the property have working connections for water, sewerage, electricity, gas, telephone and internet?

Unconnected services may not be available, or may incur a fee to connect. You may also need to choose from a range of suppliers for these services. This may be particularly important in rural areas where some services are not available.

Buyers' rights

Do you know your rights when buying a property?

The contract of sale and section 32 statement contain important information about the property, so you should request to see these and read them thoroughly. Many people engage a lawyer or conveyancer to help them understand the contracts and ensure the sale goes through correctly. If you intend to hire a professional, you should consider speaking to them before you commit to the sale. There are also important rules about the way private sales and auctions are conducted. These may include a cooling-off period and specific rights associated with 'off the plan' sales. The important thing to remember is that, as the buyer, you have rights.

